

PURCHASING ADDITIONAL FILTERS

To maintain the performance of your air purifier, **only** use official Levoit filters. To buy replacement filters, visit Levoit's online store. Go to **levoit.com** for more information.

CUSTOMER SUPPORT

Arovast Corporation
1202 N. Miller St., Suite A
Anaheim, CA 92806

Email: support@levoit.com
Toll-Free: (888) 726-8520

Support Hours
Mon–Fri, 9:00 am–5:00 pm PST/PDT

*Please have your order invoice and order ID ready before contacting Customer Support.

JJ0420GY-M1_0420LV-H132-RF

True HEPA Replacement Filters

Model: LV-H132-RF

Thank you for purchasing the Levoit True HEPA Replacement Filters. These filters are made for the Levoit LV-H132 Air Purifier. If you have any questions or concerns, please reach out to us at **support@levoit.com**.

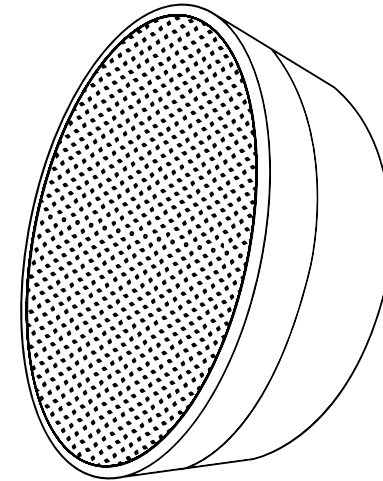

SAFETY INFORMATION

Follow all safety guidelines. Read all instructions before using.

- **Do not** allow children to play with the plastic packaging. Immediately discard the plastic after unwrapping the filters.
- A damaged filter may not properly filter air. If a filter is damaged, contact Customer Support.

Note:

- *The filters should be replaced every 6–8 months.*
- **Do not** clean the filters with water or other liquids.

REPLACING THE FILTERS

1.

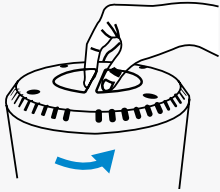

Unplug the air purifier. Flip the air purifier over and remove the filter cover.

2.

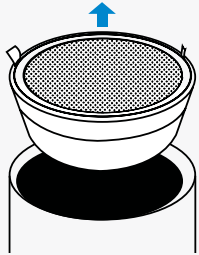

Remove the old filters.

3.

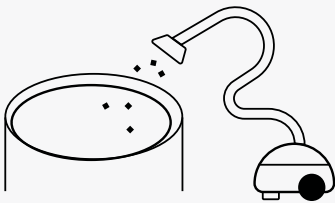

Clean any remaining dust or hair inside the air purifier using a vacuum hose.
Do not use water or liquids to clean the air purifier.

REPLACING THE FILTER (CONT.)

4.

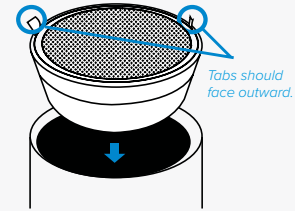

Unwrap the new filters and place them into the housing with the pull tabs facing out.

5.

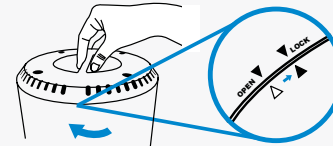

Replace the cover and plug in the air purifier.

6.

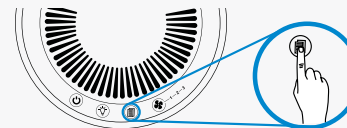

Turn on the air purifier. To reset the Check Filter Indicator, press and hold  for 3 seconds. The Check Filter Indicator should turn off.